

NOTES

- 1) Rating: AC 125V 4A 250V 2A
- 2) Contact R.: 20mΩ Max
- 3) Insulation R.: DC 500V 100MΩ Min
- 4) Dielectric Strength: AC 1500V 1 minute.
- 5) Electrical Life: 20,000 make/break cycles at full load.
- 6) Operating Temperature: -20°C ~65°C

ISS.	AMEND	DATE
1	ISSUED	24/01/07
2	P/No. ERROR	29/05/07
3	DIMS AMENDED	18/02/08
4	SPEC UPDATED	01/12/09
5	UPDATE, ADD ON/OFF	04/09/17

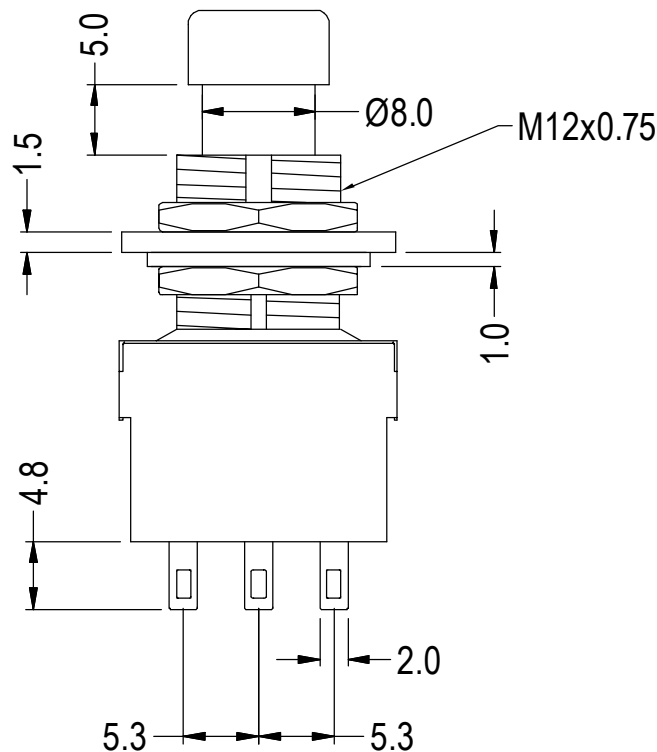
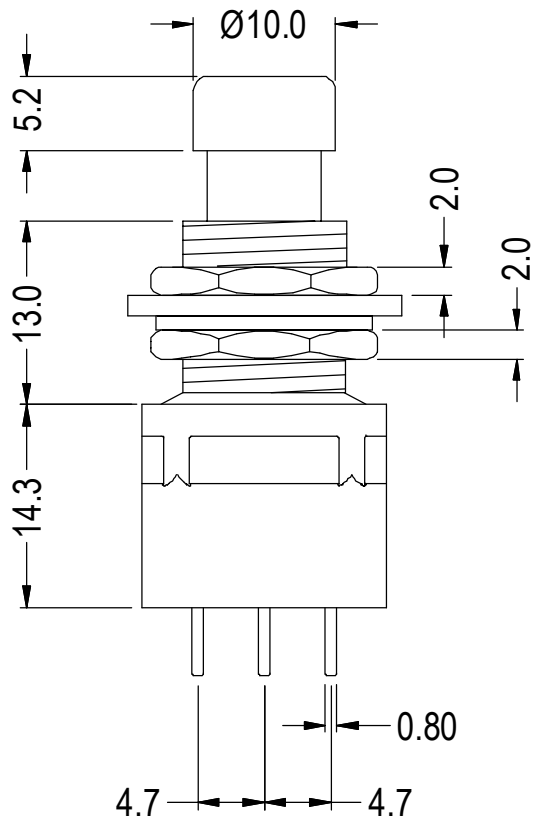

3PDT SOLDER TAG (ON / OFF)

RoHS COMPLIANT
TOLERANCE
NO DEC. PLACE ± 0.50
1 DEC. PLACE ± 0.25
2 DEC. PLACE ±
HOLE Ø ±
ANGLES ±
UNLESS
OTHERWISE STATED
DO NOT SCALE

Cliff Electronic Components Ltd.
 76 Holmehorpe Avenue, Holmehorpe Industrial Estate,
 Redhill, Surrey, RH1 2PF, England, UK
 Tel: 01737-771375 Fax: 01737-766012 Website: www.cliffuk.co.uk

THE CONTENTS OF THIS DOCUMENT MUST NOT BE COPIED OR DISCLOSED TO A 3rd PARTY WITHOUT WRITTEN PERMISSION OF CLIFF UK. © 2007

DIMENSIONS IN MILLIMETERS UNLESS OTHERWISE STATED. WORK TO DIMENSIONS. REMOVE ALL BURRS. IF IN DOUBT ASK.

MATERIAL: BRASS / STEEL / NYLON 66

FINISH: Ni HARDWARE / CONTACTS TIN PLATED / AS MOULDED

DRAWN: T.J.O. APPROVED: D.P.J.

3rd ANGLE PROJECTION:

TITLE: PUSH BUTTON SWITCH - 3PDT ST (ON / OFF)

DRWG. No. **FC71101**

FORM: A4DRWGH